



Aldburgh Mews, W1U

LUROT BRAND

MEWS SPECIALISTS EST. 1971

020 7590 9955

lettings@lurotbrand.co.uk



Ground Floor

Garden

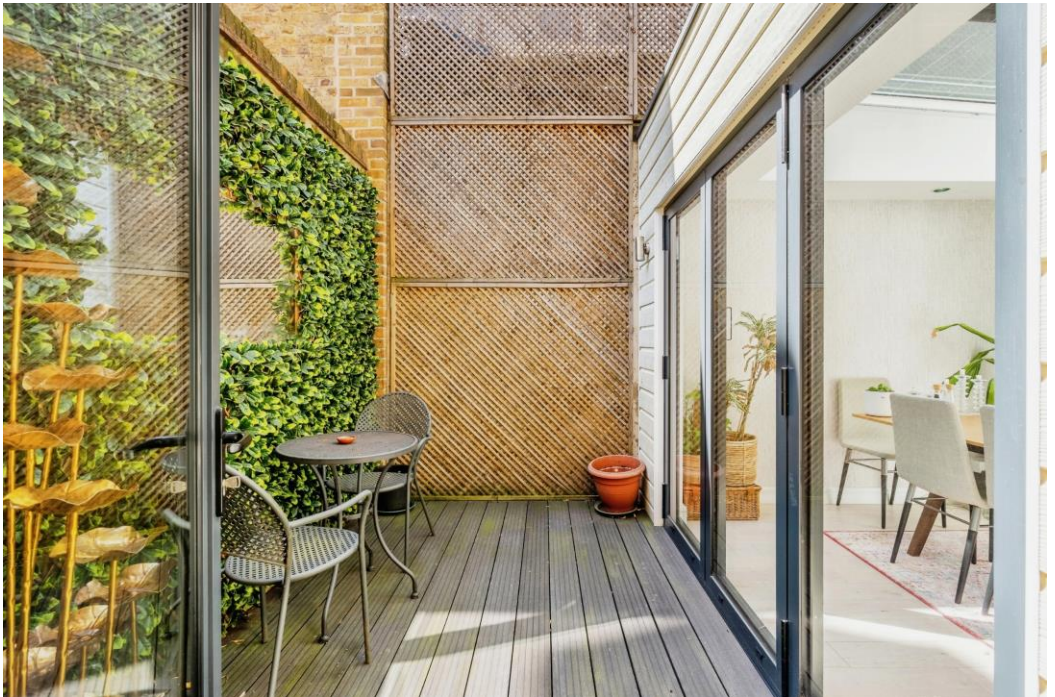

Aldburgh Mews, W1U

Furnished, Unfurnished

£1,700 PW

A stunning four-bedroom mews house located within a private, gated development in the heart of Marylebone. Spanning over three floors, this bright and spacious home boasts a skylit kitchen that leads directly onto a private terrace. The property is thoughtfully arranged, featuring four bedrooms and three bathrooms—two of which are en-suite, with one offering access to a desirable private terrace. Additional benefits include secure underground parking and access to a charming courtyard.

LOCATION

Set in the heart of Marylebone, just off of Wigmore Street. Aldburgh Mews is surrounded by restaurants, cafes and numerous shops including Selfridges. Hyde Park and Regent's Park are both within walking distance from Aldburgh Mews.



External

Second Floor





First Floor

Ground Floor



FEATURES

Four bedrooms

Three bathrooms

Skylight

Gated Mews

Private Terrace And

Courtyard

Balcony

Private garden

OTHER USEFUL INFORMATION

EPC

To be confirmed

Council Tax Band

G

Deposit Amount

£10,200.00

NEAREST TUBE STATIONS

Bond Street (and Oxford Circus (Jubilee ,Bakerloo, Victoria,
and Central lines)

Hyde Park
37-41 Sussex Place, Hyde Park,
London W2 2TH

South Kensington
4-5 Kynance Place, South Kensington,
London SW7 4QS

WWW.LUROTBRAND.CO.UK



Members of NAEA, ARLA, onthemarket.com. Lurot Brand (2) Limited T/A Lurot Brand. Registered in England No. 02035540. Registered Office: 37-41 Sussex Place, London, W2 2TH. VAT No. 629 099 505. www.lurotbrand.co.uk

We have produced these sales particulars as a general guide. We have not carried out a detailed survey of the property and have not tested the services, appliances, or specific fittings. Room sizes are for general guidance purposes and should not be relied upon for fitting carpets or furnishings. Pictures may have been digitally enhanced. Floor plans are not to scale. Fittings shown on floor plans may not match the actual layout or size of fittings at the property. None of the statements as to the property contained in these particulars are to be relied upon as statements or representations of fact. All statements in these particulars as to this property are made without responsibility on the part of Lurot Brand. The Seller does not make or give and neither Lurot Brand or any person in their employment has any authority to make or give any representation or warranty whatever in relation to this property.